



# KALBARRI 690

## 5TH WHEELER CARAVAN

*Australian-made for Australian adventures...*

The Kalbarri is slightly longer than the Ormiston, but still small in comparison to other manufacturers. A spacious interior with superior fittings and furnishings, along with safe and easy towing characteristics. Ideal for couples who want plenty of space. Alternative dinette layouts are available. The large cargo storage area is accessible externally.



### Plumbing

- 12 Volt water pressure pump
- High pressure 1½" ABS pipe and fittings on all drainage
- Truma Gas/Electric Hot water system
- External Hot/Cold Shower
- Lockable water fill with mains pressure
- Pressure reduction valve
- Water level indicators
- Fresh water tank 160ltr capacity
- Grey water tank 102ltr capacity (optional)
- Ceramic bowl cassette toilet
- External gas point
- 2 x gas bottles
- Chrome tap ware

### Appliances

- Stainless steel range hood
- CD / MP3 / Radio Player
- 3-way Fridge (optional sizes)
- Roof-top air conditioner
- Stainless microwave
- Wall mounted clock

### Interior

- Quality heavy duty vinyl floor covering
- Overhead and under bench cupboards
- Cupboard doors, drawer fronts joinery made from solid North American Oak
- Stainless steel single bowl sink
- 4 star motel quality innerspring mattress (queen)
- Hopper windows with built-in shades and screens
- Euro-style lighting throughout/reading lights over bed head and dinette/sofa area
- Fully upholstered fitted cushions/dinette/sofa
- Towel rails
- Vanity cupboard / Mirrored Cabinet
- Dressing Mirror
- Hanging Wardrobe
- Multiple storage areas

### Exterior

- Roll-out awning
- External Hot / Cold shower
- Grab handles
- External power point / light
- External gas outlet
- Cargo storage area with external hatches
- Ample battery storage

### Chassis

- Powder coated RHS 6" x 2" chassis rails
- Tandem axle
- Electric brakes (4 wheel)
- 15" steel wheels
- ALKO independent suspension
- Breakaway Switch
- 50mm towing pin
- Drop/wind down stabilizing jacks
- 4" x 4" Heavy duty bumper with internal storage & spare wheel carrier
- Manual wind down landing gear
- 2 stage drop step

### Construction

- 1" X 1½" Kiln dried Canadian Spruce wall frame
- ¾" marine grade ply floor
- 1½" x 1½" stud grade Canadian Spruce roof beams
- 3/8" structural plywood roof cover
- Single piece aluminium roof skin
- 25mm thick polyester insulation in roof and walls
- Aluminium cladding

### Electrical

- 240 volt power points
- Safety Switch/circuit breakers
- 12 volt lighting
- External power point/light
- External 12 volt socket
- Electronic monitoring of batteries and tank level indicator
- Smoke Alarm
- Prewired cable TV
- Ctek XS25000 battery charger/power supply
- Solar Pre-wiring
- TV Antenna
- Internal battery isolation switch

### Warranty

- 3 Year limited warranty

## KALBARRI 690

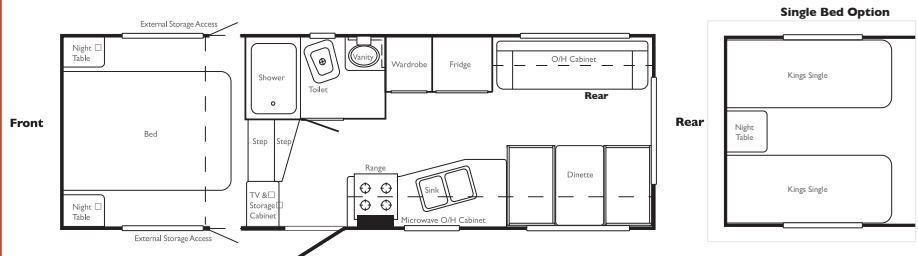

External length	External width	Internal length	Internal height	Exterior height (over A/C)	Tare weight	ATM up to	Hitch weight
7530mm	2430mm	6880mm	1960mm	3000mm	2150kg	3000kg	400kg

\*All dimensions are approximate only. Winjana RV (Adventure RV) reserves the right to change specifications and/or the design of products at any time. For more detailed Winjana RV van specifications please visit our website or ask for our individual specification brochures.

## WINJANA RV

T : (07) 4638 3576      A : 2 Buchanan St, Toowoomba QLD 4350  
 F : (07) 4613 0675      E : sales@winjana5thwheelers.com.au

Adventure RV trading as Winjana RV ABN: 59 109 062 464

