



CATTAI 760 HYBRID

5TH WHEELER CARAVAN

Australian-made for Australian adventures...

Australia's first 'hybrid' caravan and Winjana's longest 5th wheeler – offering customers the best of both worlds – the convenience of a caravan floor plan, combined with the safety of a 5th wheeler; with extra space and storage as well. The cleverly-designed spacious floor-plan includes plenty of storage space; including the large cargo area accessible externally.



Plumbing

- 12 volt water pressure pump
- High pressure 1 1/2" ABS pipe and fittings on all drainage
- Truma Gas/Electric Hot water system
- External Hot/Cold Shower
- Lockable water fill with mains pressure
- Pressure reduction valve
- Water level indicators
- Fresh water tank 160ltr capacity
- Grey water tank 102ltr capacity (optional)
- Ceramic bowl cassette toilet
- External gas point
- 2 x gas bottles
- Chrome tap ware

Appliances

- Stainless steel range hood
- CD / MP3 / Radio Player
- 3 way Fridge (optional sizes)
- Roof-top air conditioner
- Stainless microwave
- Wall mounted clock

Interior

- Quality heavy duty vinyl floor covering
- Overhead and under bench cupboards
- Cupboard doors, drawer fronts joinery made from solid North American Oak
- Stainless steel single bowl sink
- 4 star motel quality innerspring mattress (queen)
- Hopper windows with built-in shades and screens
- Euro-style lighting throughout/reading lights over bed head and dinette/sofa area
- Fully upholstered fitted cushions/dinette/sofa
- Towel rails
- Vanity cupboard / Mirrored Cabinet
- Dressing Mirror
- Hanging Wardrobe
- Multiple storage areas

Exterior

- Roll-out awning
- External Hot / Cold shower
- Grab handles
- External power point / light
- External gas outlet
- Cargo storage area with external hatches
- Ample battery storage

Chassis

- Powder coated RHS 6" x 2" chassis rails
- Tandem axle
- Electric brakes (4 wheel)
- 15" steel wheels
- ALKO independent suspension
- Breakaway Switch
- 50mm towing pin
- Drop/wind down stabilizing jacks
- 4" x 4" Heavy duty bumper with internal storage & spare wheel carrier
- Manual wind down landing gear
- 2 stage drop step

Construction

- 1" X 1 1/2" Kiln dried Canadian Spruce wall frame
- 3/4" marine grade ply floor
- 1 1/2" x 1 1/2" stud grade Canadian Spruce roof beams
- 3/8" structural plywood roof cover
- Single piece aluminium roof skin
- 25mm thick polyester insulation in roof and walls
- Aluminium cladding

Electrical

- 240 volt power points
- Safety Switch/circuit breakers
- 12 volt lighting
- External power point/light
- External 12 volt socket
- Electronic monitoring of batteries and tank level indicator
- Smoke Alarm
- Prewired cable TV
- Ctek XS25000 battery charger/power supply
- Solar Pre-wiring
- TV Antenna
- Internal battery isolation switch

Warranty

3 Year limited warranty

CATTAI 760

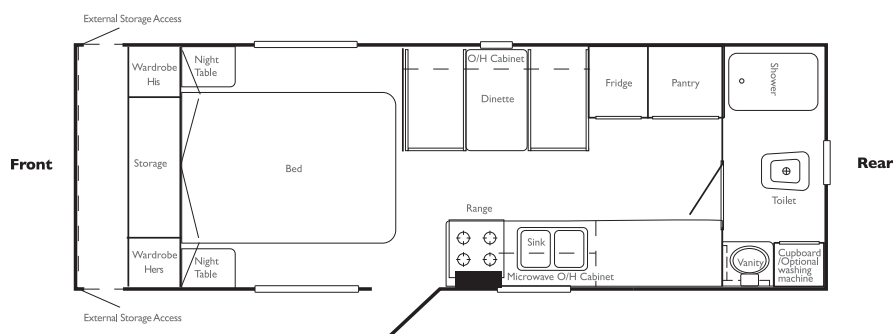

External length	External width	Internal length	Internal height	Exterior height (over A/C)	Tare weight	ATM up to	Hitch weight
8000mm	2430mm	7600mm	1960mm	3000mm	2220kg	3000kg	420kg

*All dimensions are approximate only. Winjana RV (Adventure RV) reserves the right to change specifications and/or the design of products at any time. For more detailed Winjana RV van specifications please visit our website or ask for our individual specification brochures.

WINJANA RV

T : (07) 4638 3576 A : 2 Buchanan St, Toowoomba QLD 4350
 F : (07) 4613 0675 E : sales@winjana5thwheelers.com.au

Adventure RV trading as Winjana RV ABN: 59 109 062 464



www.winjana5thwheelers.com.au